

CAM FOLLOWERS STAINLESS STEEL

SOLID ECCENTRIC TYPE HEXAGON SOCKET ON STUD HEAD

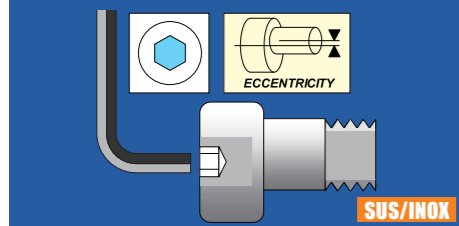

CFH..MA



CFH..VMA

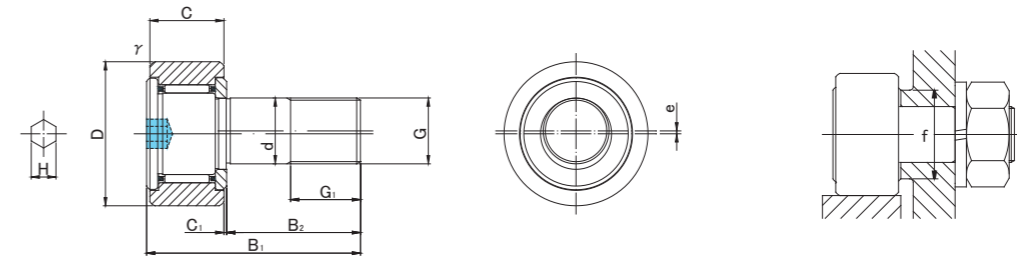

CFH..MA TYPE

Prepacked Grease

Stud diameter (mm)	Designation				Dimensions (mm)												Basic dynamic load rating	Basic static load rating	Largest permissible load	Limiting speed *	Track load capacity		Max tightening torque	Mass						
	Cylindrical outer ring		Crowned outer ring R250(CF5),R500(CF6 ~ CF10-1)		D	C	d	G	G1	B1	B2	C1	H	rs min	e	f min					Cr N	Cor N			N	rpm	Cylindrical outer ring N	Crowned outer ring N	N-m	g (approx)
	Without seals	With seals	Without seals	With seals																										
5	0	-0.012	CFH 5MA	CFH 5MUUA	CFH 5MRA	CFH 5MUURA	13	9	5	M5×0.8	7.5	23	13	0.5	2.5	0.3	0.2	9.7	2 880	2 540	1 420	29 000	2 250	530	2	10.5				
	CFH 5VMA		CFH 5VMUUA	CFH 5VMRA	CFH 5VMUURA	4 690													5 060	1 420	11 600									
6	0	-0.012	CFH 6MA	CFH 6MUUA	CFH 6MRA	CFH 6MUURA	16	11	6	M6×1	8	28	16	0.6	3	0.3	0.25	11	3 330	3 330	2 110	25 000	3 430	1 080	3	18.5				
	CFH 6VMA		CFH 6VMUUA	CFH 6VMRA	CFH 6VMUURA	6 400													7 840	2 110	12 000									
8	0	-0.015	CFH 8MA	CFH 8MUUA	CFH 8MRA	CFH 8MUURA	19	11	8	M8×1.25	10	32	20	0.6	4	0.3	0.25	13	3 960	4 330	4 710	20 000	4 020	1 370	8	28.5				
	CFH 8VMA		CFH 8VMUUA	CFH 8VMRA	CFH 8VMUURA	7 470													10 270	4 710	9 000									
10	0	-0.015	CFH10MA	CFH10MUUA	CFH10MRA	CFH10MUURA	22	12	10	M10×1.25	12	36	23	0.6	5	0.3	0.3	15	4 950	6 310	6 860	17 000	4 700	1 670	15	45				
	CFH10VMA		CFH10VMUUA	CFH10VMRA	CFH10VMUURA	8 740													13 340	7 450	7 500									
10	0	-0.015	CFH10-1MA	CFH10-1MUUA	CFH10-1MRA	CFH10-1MUURA	26	12	10	M10×1.25	12	36	23	0.6	5	0.3	0.3	15	4 950	6 310	6 860	17 000	5 490	2 060	15	60				
	CFH10-1VMA		CFH10-1VMUUA	CFH10-1VMRA	CFH10-1VMUURA	8 740													13 340	7 450	7 500									

* Without seals, suitable for grease lubrication. In case of oil lubrication, up to 130% of this value shall be permissible, and 70% of this value shall apply for types with seals.

TYPE	Cylindrical outer ring	Crowned outer ring
CF5M,CF6M	0/-8	0/-50
CF8M,CF10M,CF10-1M	0/-9	0/-50

TYPE	STAINLESS NUT
CF3M/CF4M/CF5M	Attached
CF6M/CF8M/CF10M/CF10-1M	Attached