

CAM FOLLOWERS
STAINLESS STEEL
HEXAGON SOCKET ON STUD HEAD

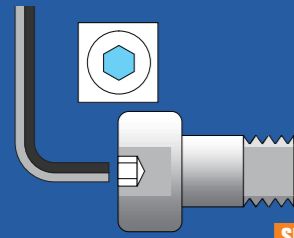

SUS/INOX



CF..MA



CF..VMA

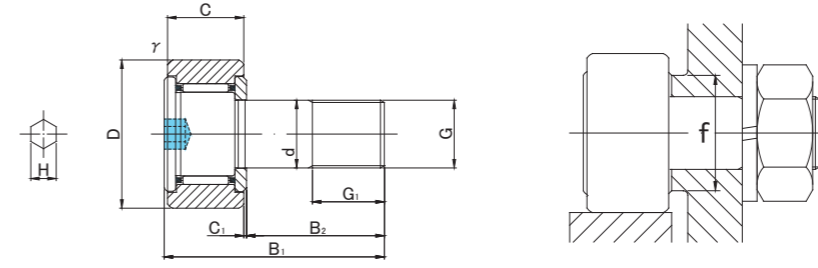

CF..MA TYPE

Prepacked Grease

Stud diameter (mm)	Designation				Dimensions (mm)												Basic dynamic load rating	Basic static load rating	Largest permissible load	Limiting speed *	Track load capacity		Max tightening torque	Mass					
	Cylindrical outer ring		Crowned outer ring R250(CF3 ~ CF5) R500(CF6 ~ CF10-1)		D	C	d	G	G1	B1	B2	C1	H	r _s min	f min	Cr N					Cor N	N			rpm	Cylindrical outer ring N	Crowned outer ring N	N·m	g (approx)
	Without seals	With seals	Without seals	With seals																									
3	0 -0.010	CF 3MA	CF 3MUUA	CF 3MRA	CF 3MUURA	10	7	3	M3×0.5	5	17	9	0.5	1.5	0.2	6.8	1 350	1 080	360	47 000	1 370	370	0.4	4.5					
		CF 3VMA	CF 3VMUUA	CF 3VMRA	CF 3VMUURA																								
4	0 -0.012	CF 4MA	CF 4MUUA	CF 4MRA	CF 4MUURA	12	8	4	M4×0.7	6	20	11	0.5	2	0.3	8.6	1 890	1 880	780	37 000	1 760	470	1	7.5					
		CF 4VMA	CF 4VMUUA	CF 4VMRA	CF 4VMUURA																								
5	0 -0.012	CF 5MA	CF 5MUUA	CF 5MRA	CF 5MUURA	13	9	5	M5×0.8	7.5	23	13	0.5	2.5	0.3	9.7	2 880	2 540	1 420	29 000	2 250	530	2	10.5					
		CF 5VMA	CF 5VMUUA	CF 5VMRA	CF 5VMUURA																								
6	0 -0.012	CF 6MA	CF 6MUUA	CF 6MRA	CF 6MUURA	16	11	6	M6×1	8	28	16	0.6	3	0.3	11	3 330	3 330	2 110	25 000	3 430	1 080	3	18.5					
		CF 6VMA	CF 6VMUUA	CF 6VMRA	CF 6VMUURA																								
8	0 -0.015	CF 8MA	CF 8MUUA	CF 8MRA	CF 8MUURA	19	11	8	M8×1.25	10	32	20	0.6	4	0.3	13	3 960	4 330	4 710	20 000	4 020	1 370	8	28.5					
		CF 8VMA	CF 8VMUUA	CF 8VMRA	CF 8VMUURA																								
10	0 -0.015	CF10MA	CF10MUUA	CF10MRA	CF10MUURA	22	12	10	M10×1.25	12	36	23	0.6	5	0.3	15	4 950	6 310	6 860	17 000	4 700	1 670	15	45					
		CF10VMA	CF10VMUUA	CF10VMRA	CF10VMUURA																								
10	0 -0.015	CF10-1MA	CF10-1MUUA	CF10-1MRA	CF10-1MUURA	26	12	10	M10×1.25	12	36	23	0.6	5	0.3	15	4 950	6 310	6 860	17 000	5 490	2 060	15	60					
		CF10-1VMA	CF10-1VMUUA	CF10-1VMRA	CF10-1VMUURA																								

* Without seals, suitable for grease lubrication. In case of oil lubrication, up to 130% of this value shall be permissible, and 70% of this value shall apply for types with seals.

OUTER RINGS TOLERANCE (μm)

TYPE	Cylindrical outer ring	Crowned outer ring
CF3M,CF4M,CF5M,CF6M	0/-8	0/-50
CF8M,CF10M,CF10-1M	0/-9	0/-50

ACCESSORIES

TYPE	STAINLESS NUT
CF3M/CF4M/CF5M/CF6M/CF8M/CF10M/CF10-1M	Attached

CF..MA

CF..MA