

# COMBINED NEEDLE ROLLER BEARINGS

WITH AXIAL BALL BEARINGS WITH INNER RINGS

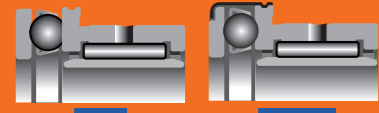

NKXI

NKXI.Z



NKXI



NKXI.Z

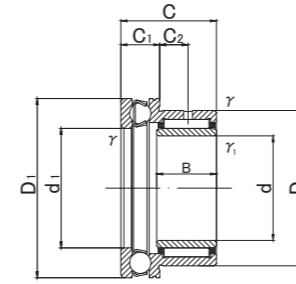

NKXI

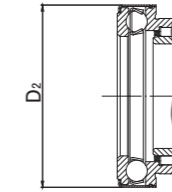

NKXI.Z

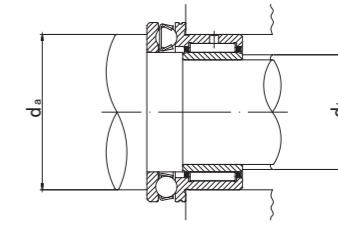

## NKXI, NKXI.Z TYPE

| Shaft diameter (mm) | Designation                         |                 | Dimensions (mm)      |    |    |      |    |    |    |      |                    |                     | Standard mounting dimensions (mm) |        | Basic dynamic load rating |        | Basic static load rating |         | Limiting speed (Grease)* | Mass (approx.) | Usable bearing designation |        |            |            |
|---------------------|-------------------------------------|-----------------|----------------------|----|----|------|----|----|----|------|--------------------|---------------------|-----------------------------------|--------|---------------------------|--------|--------------------------|---------|--------------------------|----------------|----------------------------|--------|------------|------------|
|                     | Open type                           | With dust cover |                      |    |    |      |    |    |    |      |                    |                     |                                   |        | Radial                    | Radial | Radial                   | Radial  |                          |                | rpm                        | g      | OUTER RING | INNER RING |
|                     | Grease pre-packed in thrust section |                 | d                    | D  | D1 | D2   | B  | C  | C1 | C2   | r <sub>s</sub> min | r <sub>s1</sub> min | d1                                | da MIN | db                        | Cr N   | Cor N                    | Cor N   |                          |                |                            |        | Cor N      | OUTER RING |
| 7                   | NKXI 7                              | —               | 7 <sub>0</sub>       | 19 | 24 | 25   | 16 | 23 | 9  | 6.5  | 0.3                | 0.3                 | 10                                | 18     | 9                         | 8 200  | 10 000                   | 9 200   | 14 000                   | 9 500          | 41                         | NKX10  | IR71016    |            |
|                     | —                                   | NKXI 7Z         | 7 <sub>-0.008</sub>  | 19 | 24 | 25   | 16 | 23 | 9  | 6.5  | 0.3                | 0.3                 | 10                                | 18     | 9                         | 8 200  | 10 000                   | 9 200   | 14 000                   | 9 500          | 42.5                       | NKX10Z | IR71016    |            |
| 9                   | NKXI 9                              | —               | 9 <sub>0</sub>       | 21 | 26 | 27   | 16 | 23 | 9  | 6.5  | 0.3                | 0.3                 | 12                                | 20     | 11                        | 9 200  | 10 300                   | 11 200  | 15 400                   | 9 200          | 46.5                       | NKX12  | IR91216    |            |
|                     | —                                   | NKXI 9Z         | 9 <sub>-0.008</sub>  | 21 | 26 | 27   | 16 | 23 | 9  | 6.5  | 0.3                | 0.3                 | 12                                | 20     | 11                        | 9 200  | 10 300                   | 11 200  | 15 400                   | 9 200          | 48                         | NKX12Z | IR91216    |            |
| 12                  | NKXI 12                             | —               | 12 <sub>0</sub>      | 24 | 28 | 29   | 16 | 23 | 9  | 6.5  | 0.3                | 0.3                 | 15                                | 23     | 14                        | 12 400 | 10 500                   | 14 900  | 16 800                   | 8 800          | 51.8                       | NKX15  | IR121516   |            |
|                     | —                                   | NKXI 12Z        | 12 <sub>-0.008</sub> | 24 | 28 | 29   | 16 | 23 | 9  | 6.5  | 0.3                | 0.3                 | 15                                | 23     | 14                        | 12 400 | 10 500                   | 14 900  | 16 800                   | 8 800          | 53.3                       | NKX15Z | IR121516   |            |
| 14                  | NKXI 14                             | —               | 14 <sub>0</sub>      | 26 | 30 | 31   | 17 | 25 | 9  | 8    | 0.3                | 0.3                 | 17                                | 25     | 16                        | 12 800 | 10 800                   | 16 300  | 18 200                   | 8 500          | 61.5                       | NKX17  | IR141717   |            |
|                     | —                                   | NKXI 14Z        | 14 <sub>-0.008</sub> | 26 | 30 | 31   | 17 | 25 | 9  | 8    | 0.3                | 0.3                 | 17                                | 25     | 16                        | 12 800 | 10 800                   | 16 300  | 18 200                   | 8 500          | 63                         | NKX17Z | IR141717   |            |
| 17                  | NKXI 17                             | —               | 17 <sub>0</sub>      | 30 | 35 | 36   | 20 | 30 | 10 | 10.5 | 0.3                | 0.3                 | 20                                | 29     | 19                        | 17 600 | 14 200                   | 25 400  | 24 700                   | 7 500          | 97                         | NKX20  | IR172020   |            |
|                     | —                                   | NKXI 17Z        | 17 <sub>-0.008</sub> | 30 | 35 | 36   | 20 | 30 | 10 | 10.5 | 0.3                | 0.3                 | 20                                | 29     | 19                        | 17 600 | 14 200                   | 25 400  | 24 700                   | 7 500          | 99.5                       | NKX20Z | IR172020   |            |
| 20                  | NKXI 20                             | —               | 20 <sub>0</sub>      | 37 | 42 | 43   | 20 | 30 | 11 | 9.5  | 0.6                | 0.3                 | 25                                | 35     | 24                        | 20 000 | 19 600                   | 32 200  | 37 300                   | 6 500          | 151.5                      | NKX25  | IR202520   |            |
|                     | —                                   | NKXI 20Z        | 20 <sub>-0.010</sub> | 37 | 42 | 43   | 20 | 30 | 11 | 9.5  | 0.6                | 0.3                 | 25                                | 35     | 24                        | 20 000 | 19 600                   | 32 200  | 37 300                   | 6 500          | 154.5                      | NKX25Z | IR202520   |            |
| 25                  | NKXI 25                             | —               | 25 <sub>0</sub>      | 42 | 47 | 48   | 20 | 30 | 11 | 9.5  | 0.6                | 0.3                 | 30                                | 40     | 29                        | 25 100 | 20 400                   | 40 100  | 42 200                   | 6 200          | 174.5                      | NKX30  | IR253020   |            |
|                     | —                                   | NKXI 25Z        | 25 <sub>-0.010</sub> | 42 | 47 | 48   | 20 | 30 | 11 | 9.5  | 0.6                | 0.3                 | 30                                | 40     | 29                        | 25 100 | 20 400                   | 40 100  | 42 200                   | 6 200          | 178                        | NKX30Z | IR253020   |            |
| 30                  | NKXI 30                             | —               | 30 <sub>0</sub>      | 47 | 52 | 53   | 20 | 30 | 12 | 9    | 0.6                | 0.3                 | 35                                | 45     | 34                        | 27 000 | 20 400                   | 46 200  | 44 700                   | 5 600          | 201.5                      | NKX35  | IR303520   |            |
|                     | —                                   | NKXI 30Z        | 30 <sub>-0.010</sub> | 47 | 52 | 53   | 20 | 30 | 12 | 9    | 0.6                | 0.3                 | 35                                | 45     | 34                        | 27 000 | 20 400                   | 46 200  | 44 700                   | 5 600          | 206                        | NKX35Z | IR303520   |            |
| 35                  | NKXI 35                             | —               | 35 <sub>0</sub>      | 52 | 60 | 61   | 20 | 32 | 13 | 10   | 0.6                | 0.3                 | 40                                | 52     | 39                        | 29 400 | 26 900                   | 54 100  | 62 900                   | 5 000          | 260                        | NKX40  | IR354020   |            |
|                     | —                                   | NKXI 35Z        | 35 <sub>-0.012</sub> | 52 | 60 | 61   | 20 | 32 | 13 | 10   | 0.6                | 0.3                 | 40                                | 52     | 39                        | 29 400 | 26 900                   | 54 100  | 62 900                   | 5 000          | 266                        | NKX40Z | IR354020   |            |
| 40                  | NKXI 40                             | —               | 40 <sub>0</sub>      | 58 | 65 | 66.5 | 20 | 32 | 14 | 9    | 0.6                | 0.3                 | 45                                | 57     | 44                        | 31 100 | 27 900                   | 60 100  | 69 200                   | 4 600          | 302                        | NKX45  | IR404520   |            |
|                     | —                                   | NKXI 40Z        | 40 <sub>-0.012</sub> | 58 | 65 | 66.5 | 20 | 32 | 14 | 9    | 0.6                | 0.3                 | 45                                | 57     | 44                        | 31 100 | 27 900                   | 60 100  | 69 200                   | 4 600          | 315.5                      | NKX45Z | IR404520   |            |
| 45                  | NKXI 45                             | —               | 45 <sub>0</sub>      | 62 | 70 | 71.5 | 25 | 35 | 14 | 10   | 0.6                | 0.6                 | 50                                | 62     | 49                        | 43 000 | 28 700                   | 85 200  | 75 400                   | 4 500          | 348                        | NKX50  | IR455025   |            |
|                     | —                                   | NKXI 45Z        | 45 <sub>-0.012</sub> | 62 | 70 | 71.5 | 25 | 35 | 14 | 10   | 0.6                | 0.6                 | 50                                | 62     | 49                        | 43 000 | 28 700                   | 85 200  | 75 400                   | 4 500          | 362.5                      | NKX50Z | IR455025   |            |
| 50                  | NKXI 50                             | —               | 50 <sub>0</sub>      | 72 | 85 | 86.5 | 25 | 40 | 17 | 12   | 1                  | 1                   | 60                                | 75     | 59                        | 47 500 | 41 400                   | 103 000 | 113 000                  | 3 700          | 606                        | NKX60  | IR506025   |            |
|                     | —                                   | NKXI 50Z        | 50 <sub>-0.012</sub> | 72 | 85 | 86.5 | 25 | 40 | 17 | 12   | 1                  | 1                   | 60                                | 75     | 59                        | 47 500 | 41 400                   | 103 000 | 113 000                  | 3 700          | 628.5                      | NKX60Z | IR506025   |            |
| 60                  | NKXI 60                             | —               | 60 <sub>0</sub>      | 85 | 95 | 96.5 | 25 | 40 | 18 | 11   | 1                  | 1                   | 70                                | 85     | 68                        | 55 500 | 43 100                   | 120 600 | 127 000                  | 3 400          | 772                        | NKX70  | IR607025   |            |
|                     | —                                   | NKXI 60Z        | 60 <sub>-0.015</sub> | 85 | 95 | 96.5 | 25 | 40 | 18 | 11   | 1                  | 1                   | 70                                | 85     | 68                        | 55 500 | 43 100                   | 120 600 | 127 000                  | 3 400          | 796                        | NKX70Z | IR607025   |            |

\* Suitable for oil lubrication. In case of grease lubrication, down to 70% of this value.